

**OPERATING FREQUENCY:** The detector is configured to operate at a fundamental operating frequency of 9.3 kHz.

Read the instruction manual for more detailed information  
 Lea el manual de instrucciones para obtener información más detallada  
 Leia o manual de instruções para informações mais detalhadas



✉ minelab@minelab.ae  
 ☎ +971 4 254 9995  
**Middle East & Africa**

✉ info@minelabamericas.com  
 ☎ +1 630 401 8150  
**North, South & Central America**

✉ minelab@minelab.ie  
 ☎ +353 21 423 2352  
**Europe & Russia**

✉ minelab@minelab.com.au  
 ☎ +61 8 8238 0888  
**Australia & Asia Pacific**



Guía de Inicio Rápido

Quick Start Guide

# SD2300

**Unpack**  
 Abra o detector

**Desempaquete el detector**

**Insert Batteries**  
 Coloque as baterías

**Inserte las baterías**

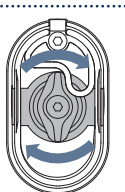
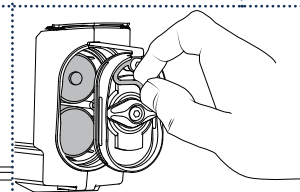
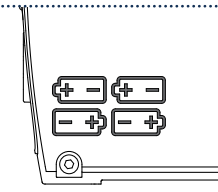
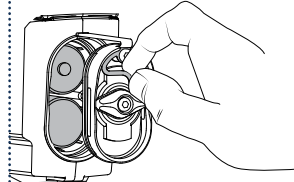
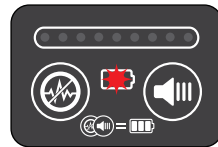
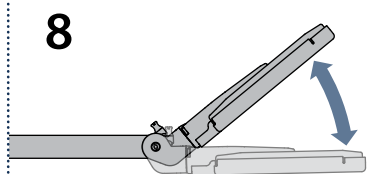
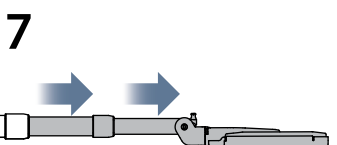
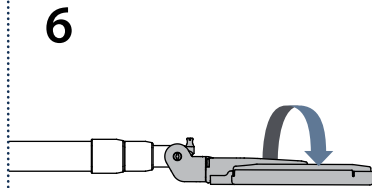
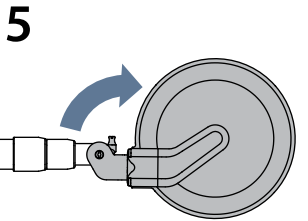
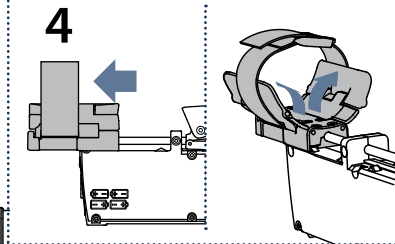
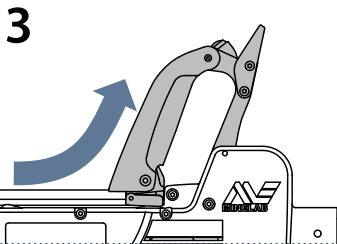
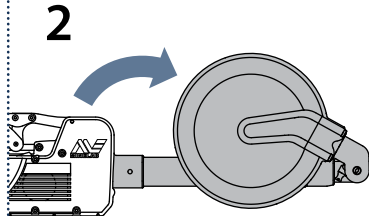
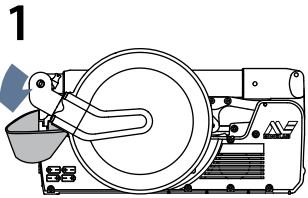

**Connect Headphones**  
 Conecte os fones de ouvido

**Conecte los auriculares**

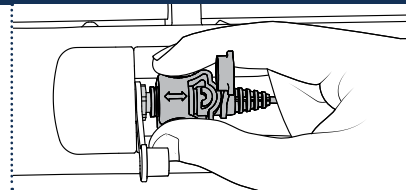

**Pack Up**  
 Feche o detector

**Empaquete el detector**

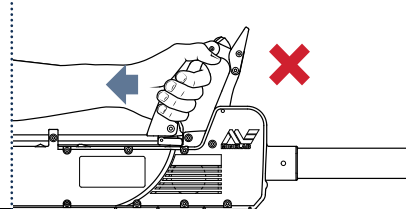
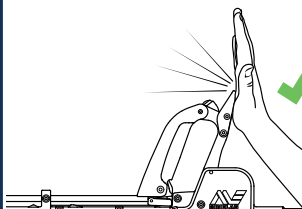

## Setup

## Configuraciones

## Ajustes

### 1

Set default Sensitivity  
 Ajustar la sensibilidad estándar  
 Ajustar à Sensibilidade padrão

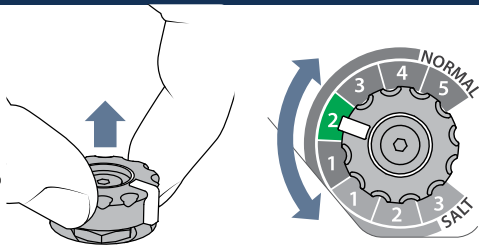

### 4

Set Threshold  
 Ajustar el umbral  
 Ajustar o Tom Limiar



### 2

Turn On  
 Encender el detector  
 Ligar o Detector

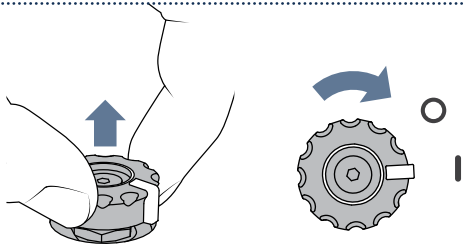

### 5

Ground Balance  
 Realizar el Balance de Tierra  
 Realizar o Equilíbrio de Solo

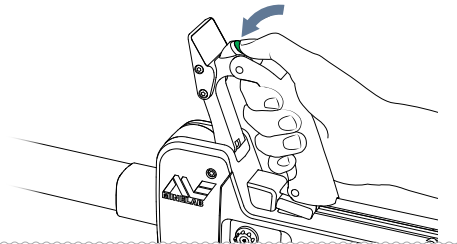

### 3

Noise Cancel  
 Cancelar el Ruido  
 Cancelar Ruído

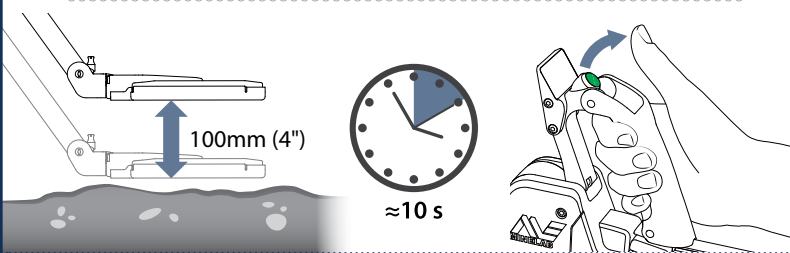

### 6

Start Detecting  
 Empezar la Detección  
 Começar a Deteção

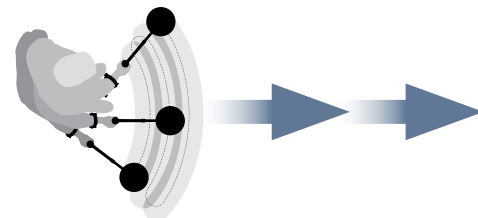

## Detecting Basics

## Detección Básica

## Deteção Básica

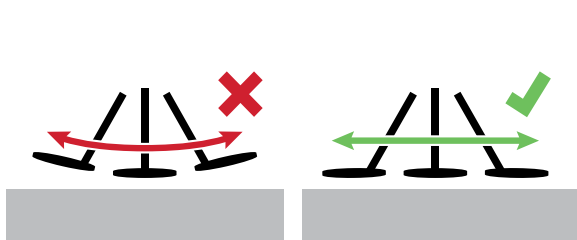

Sweep level  
 Nivel del barrido  
 Nível da varredura

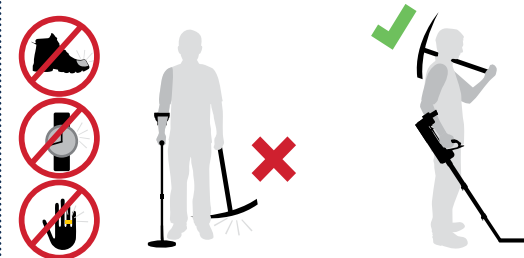

Keep metal away from coil  
 Mantenga los metales lejos de la bobina  
 Mantenha metais afastados da bobina

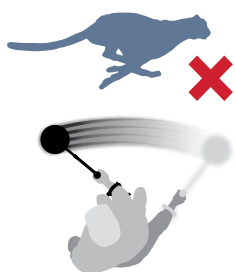

Sweep slowly  
 Barra lentamente  
 Varra lentamente

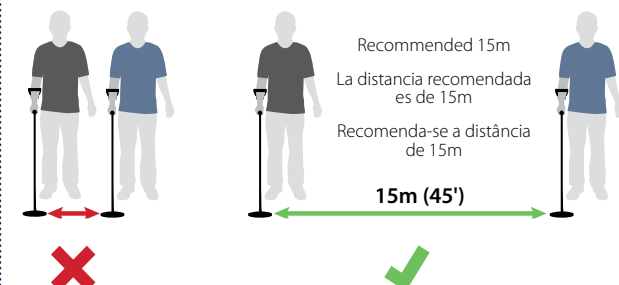

Recommended 15m  
 La distancia recomendada es de 15m  
 Recomenda-se a distância de 15m

Move apart  
 Manténgase lejos de otros detectores  
 Afaste-se de outros detectores



Overlap sweep  
 Superposición del barrido  
 Sobreponha a varredura



Refill hole  
 Vuelva a llenar el agujero  
 Tape o buraco